

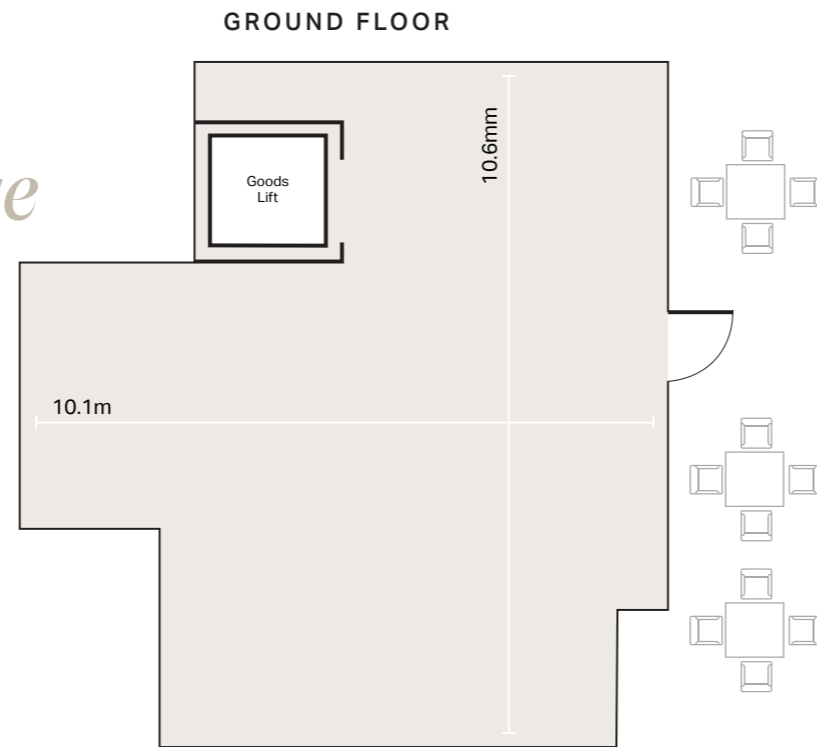

FOUR

4,365 sq ft Mary Lavin Place / Lad Lane



LOWER GROUND FLOOR



SPECIFICATION

- Prominent corner glazed unit fronting Lad Lane and feature landscape installations
- 3.3m floor to ceiling height
- Floor to ceiling glazed shopfront
- Open created for internal stairwell linking to lower ground floor
- Lift access to lower ground floor and basement for deliveries and waste removal
- Alternative lift and stair well access from Lad Lane with lightwell to lower ground floor
- Water, power and extraction services ready for connection

WILTON PARK

