

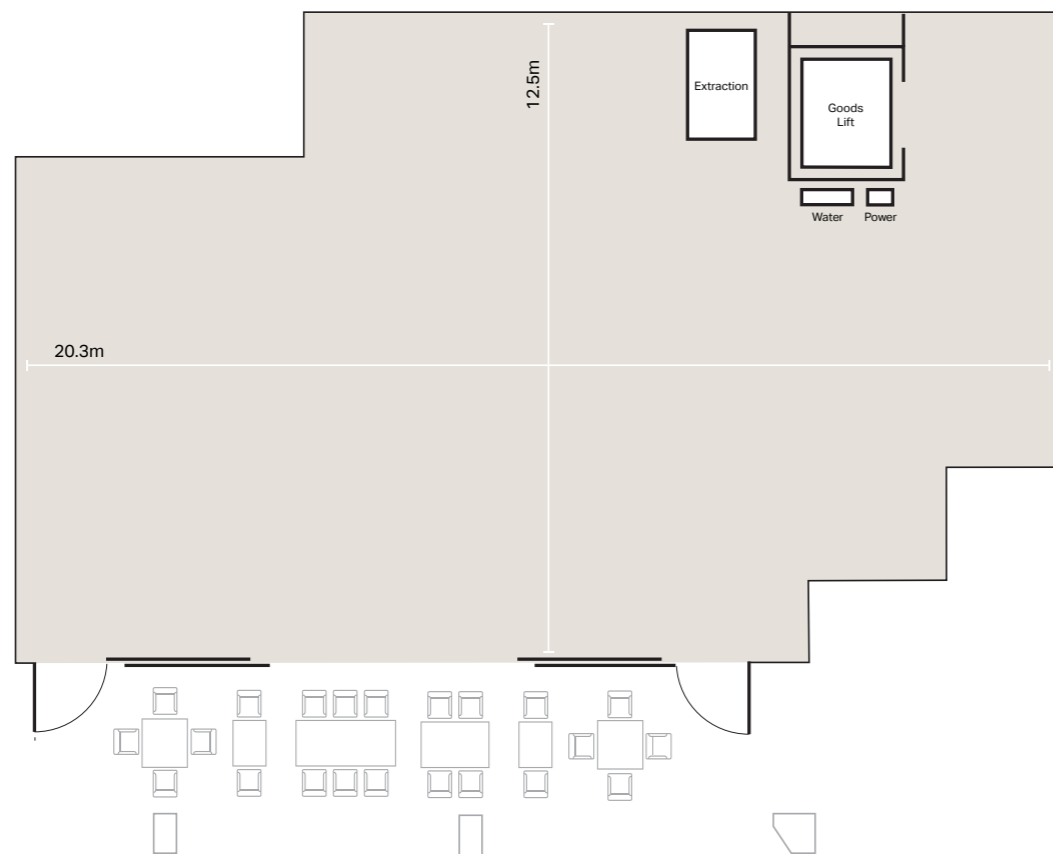

# ONE

2,424 sq ft  
*Parkside*



## SPECIFICATION

- 15m frontage to Wilton Park
- 3.1m floor to ceiling height
- Floor to ceiling glazed shopfront
- Double sliding doors for covered al fresco dining
- Dedicated lift to basement for deliveries and waste removal
- Water, power and extraction services ready for connection

